

No 60.

2140  
OHIO 583

2209  
No 2209

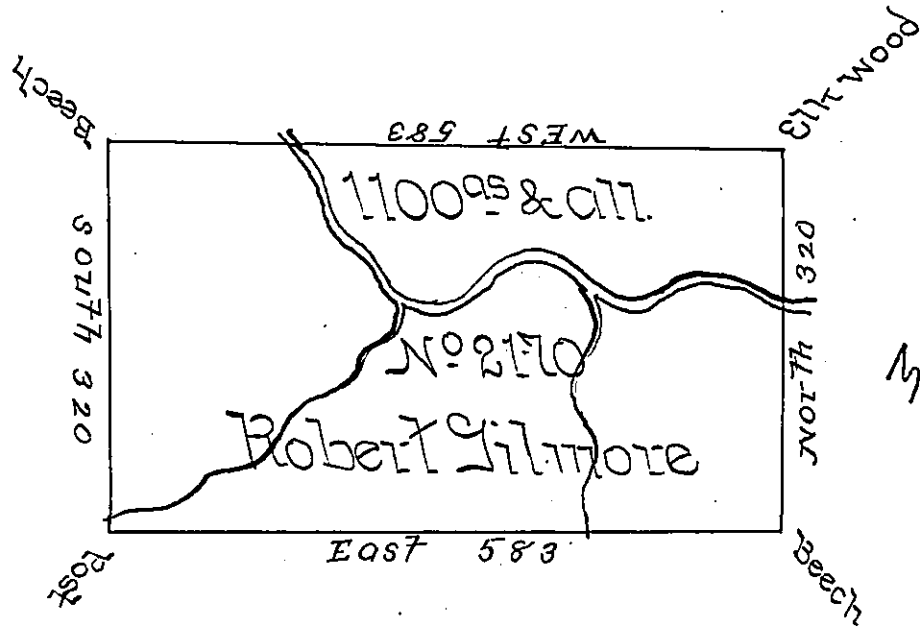

3741

No 2161

2161

Situate on the Waters of the Oswayo Creek about four Miles West of the six mile Tree in North<sup>d</sup> County containing 1100 Acres and the usual Allowance for Roads &c Surveyed June 20<sup>th</sup> 1793 for Robert Gilmore in pursuance of a Warrant No 2170 bearing date 12<sup>th</sup> of December 1792

John Canon DS.

Daniel Brodhead Esq<sup>r</sup> S. J.

IN TESTIMONY that the above is a copy of the original remaining on file in the Department of Internal Affairs of Pennsylvania, made conformably to an Act of Assembly approved the 16th day of February, 1833, I have hereunto set my Hand and caused the Seal of said Department to be affixed at Harrisburg, this first day of November 1898.

*James W. Pitta*  
Secretary of Internal Affairs.